

QUANTUM LT SERIES

USB Audio Interfaces



OWNER'S MANUAL

Fender[®]

Table of Contents

1	Overview	1	5	Using Your Quantum LT	11
1.1	Introduction	1	5.1	Volume Control	11
2	Getting Started	2	5.2	Setting a Channel's Gain Level	11
2.1	Installation and Setup	2	5.3	Changing Line Input Level (Quantum LT 16 Only)	11
2.2	Firmware Updates	3	5.4	Monitor Without Latency	11
2.3	Hardware Setup	3	5.5	Using the Quantum LT as a Standalone Mixer	12
3	Hardware Features	4	5.6	Standalone "Mic Pre Mode" (Quantum LT 16 only)	12
3.1	Front Panel (Quantum LT 16)	4	6	Resources	13
3.2	Front Panel (Quantum LT 4 and LT 2)	5	6.1	Specifications	13
3.3	Back Panel (Quantum LT 16)	6			
3.4	Back Panel (Quantum LT 4 and LT 2)	7			
3.5	Quantum LT 16 Hookup Diagram	7			
3.6	Quantum LT 4 Hookup Diagram	8			
3.7	Quantum LT 2 Hookup Diagram	8			
4	Software Features	9			
4.1	Universal Control	9			
4.2	Fender Studio Pro and Other Popular DAWs	9			

1 Overview

1.1 Introduction



Thank you for purchasing a Fender Quantum LT Audio Interface! The Fender Quantum LT Series combines incredible sound quality, intuitive design, modern aesthetics, and flexible analog I/O for songwriters, music producers, creators, and educators alike. With ultra-low-latency custom drivers, MAX-HD microphone preamps, Fender-designed instrument inputs, and seamless integration with Fender Studio® Pro and Universal Control, Fender Quantum LT ensures pristine audio capture and easy monitoring.

About this manual: We suggest that you use this manual to familiarize yourself with the features, applications, and correct connection procedures for your Quantum LT before connecting it to your computer. This will help you avoid problems during installation and setup. This manual covers the operation of the Quantum LT 2, Quantum LT 4, and Quantum LT 16. Whenever a functional difference is described, the Quantum LT 16's features will be called out first, followed by the Quantum LT 4 and Quantum LT 2.

1.2 What's in the Box

You Quantum LT interface package contains the following:



Quantum LT 16, Quantum LT 4, or Quantum LT 2 USB Audio Interface

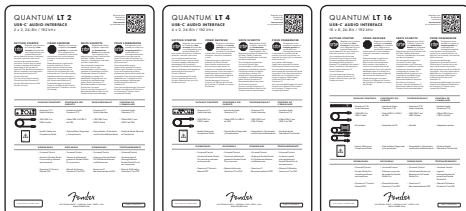

Your Quantum LT Quick Start Guide

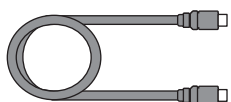

1.5M USB-C to USB-C cable

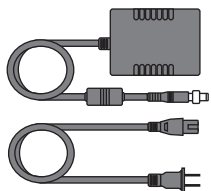

Power Supply Connector (**LT 16 Only**)



Health, Safety and Compliance Guide

All companion software and drivers for your Quantum LT interface are available for download from your MyFender user account. Simply visit <http://my.fender.com> and register your Quantum LT interface to receive downloads and licenses. [For more info on product registration and downloading Universal Control, see section 2.](#)

If you have no Fender account, but have previously created a **MyPreSonus account**, you can use these credentials on [My.Fender.com](#) to log in. All of your previous registered PreSonus products will be available from the new unified MyFender account experience.

2 Getting Started

There's more to your Quantum LT Interface than what comes in the box! Let's take a moment to register your interface and download the **Fender Universal Control** app. Universal Control is required to take advantage of the full functionality of your Quantum LT and provides updates and upgrades for the Quantum LT, so make sure to follow the directions below to ensure you get the most out of your new interface.

2.1 Installation and Setup

On both Windows and macOS computers, when you connect your Quantum LT Series interface to your computer, it will appear on the desktop as a mounted device, like a USB or disk drive. To begin installation, open the drive and double click the URL inside.

Note: You can also navigate directly to my.fender.com in your web browser to register and download software.

2.1.1 Getting Started (macOS)

1. Connect your device to a computer using the included USB-C cable.
2. The device will appear on your desktop as a mounted device titled **Quantum LT (#)**:



Note: you may need to grant permission in your operating system when connecting for the first time.

3. Double-click the icon to open the Finder window, which will contain the "Get Started" URL for the Quantum LT interface:

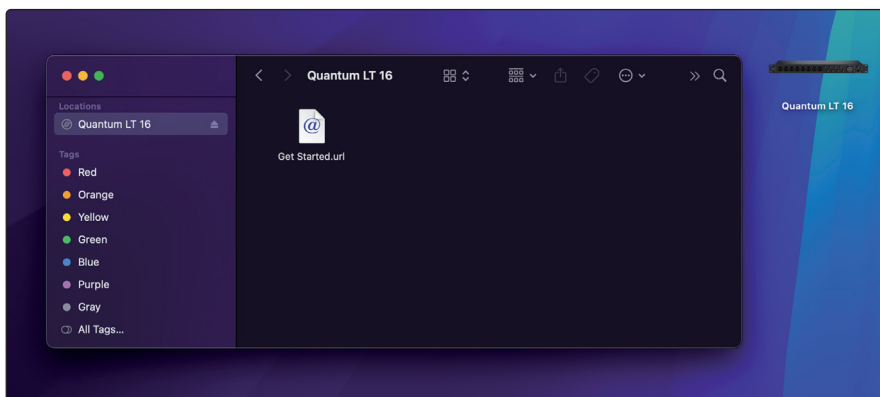

4. Double-click "Get Started" to be redirected to the MyFender website, where you can create an account, register your device and download Universal Control, Fender Studio Pro and other included software.

Note: The "Get Started" feature can be disabled in the Quantum LT settings menu (click onto the gear icon in the control panel to access the settings) in Universal Control:

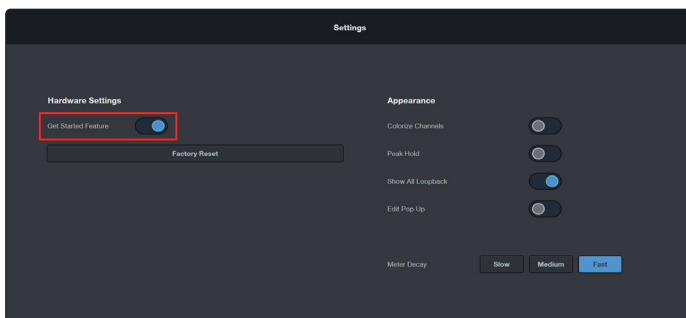

2.1.2 Getting Started (Windows)

1. Connect your device to a computer using the included USB-C cable.
2. The Quantum LT will appear in File Explorer as a mounted device titled **Quantum LT (#)**:

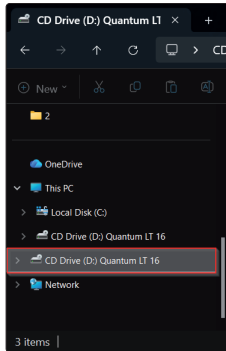

3. Click on the device to access the “Get Started” URL for your Quantum LT interface:

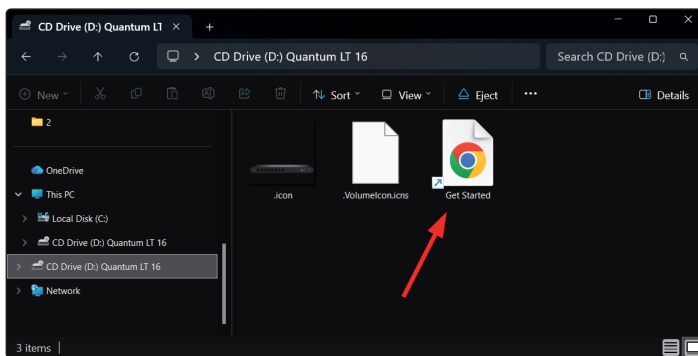

4. Double-click “Get Started” to be redirected to the MyFender website, where you can create an account, register your device and download the Fender Universal Control app, Fender Studio Pro and other included software. **Note:** The “Get Started” feature can be disabled in the Quantum LT settings menu (click onto the gear icon in the control panel to access the settings) in Universal Control.

2.1.3 Getting Started URLs

If you would like to quickly access the Getting Started registration page, click on the appropriate link below:

Quantum LT 2: <https://www.fender.com/QUANTUMLT2/register>

Quantum LT 4: <https://www.fender.com/QUANTUMLT4/register>

Quantum LT 16: <https://www.fender.com/QUANTUMLT16/register>

2.2 Firmware Updates

The Fender Universal Control app is designed to verify that your Quantum LT interface has the correct firmware version installed. You will be prompted if your Quantum LT interface needs its firmware updated. Once prompted, click on the “Update Firmware” button to begin the update.



WARNING: Do not power off or disconnect your Quantum interface during the firmware update. Once the firmware update is successfully completed, you will be alerted and instructed to reboot your device if necessary.

2.3 Hardware Setup

Now that you’ve registered your interface and downloaded Universal Control, you’re ready to start using your new Quantum LT! Follow the steps below to connect your Quantum LT to the computer:

1. For those with a Quantum LT 16, connect the Power Supply Connector from the power outlet to your Quantum LT.
2. Connect your monitor speakers, headphones, MIDI device, or any other compatible instrument to the interface. [For more information about I/O connections, refer to the Quantum LT Hookup Diagrams.](#)



Caution: Before powering the Quantum LT, lower the volume of your monitor speakers and remove headphones from your ears.

3. Connect the provided USB-C to USB-C cable from your Quantum LT to the host computer.
4. Apply power to Quantum LT 16 by pressing the power button. Quantum LT 4 and LT 2 interfaces will power on as soon as they are connected to the host computer via the provided USB-C cable.

3 Hardware Features

The following section provides an overview of the front and back panel connections and controls for all of the Quantum LT interfaces.

3.1 Front Panel (Quantum LT 16)



Phantom Power - Pressing the 48V button will turn phantom power on or off for a group of channels; the button will illuminate red when 48V is engaged (blue when not engaged). Phantom power can be engaged in two groups for mic pre channels (1 - 4 and 5 - 8).



Warning: Phantom power can damage some microphones. Check the manual for your microphone before engaging phantom power while using it. Always turn down your volume when engaging and disengaging phantom power.

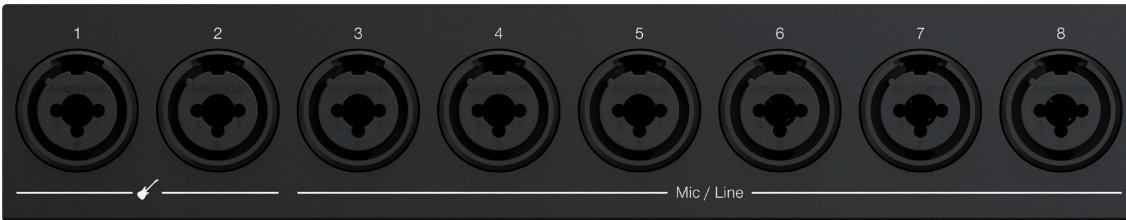

Fender Guitar Inputs (Ch 1 - 2) - Use the 1/4-inch instrument level inputs of the combo jack to connect guitars and basses.

MAX-HD Microphone Preamps (CH 1 - 8) - The Quantum LT 16 features Fender MAX-HD microphone preamplifiers for use with many types of microphones. MAX-HD preamps are ultra-low noise with a gain range of 0 to +75dB, allowing you to boost signals with minimum background noise. The front panel combo line inputs have a gain range of 0 to +26 dB to apply additional gain to line-level sources if desired. Use the XLR connector of the combo jack to connect microphones or the 1/4-inch connector of the combo jack to connect to line level (Ch 3 - 8) devices. Channels 1 - 2 are Mic / Instrument, while channels 3 - 8 are Mic / Line.

Note: Connecting a line level device through the 1/4-inch TRS input of the combo jack will bypass the mic pre.



Channel Gain Knobs - Use these knobs to adjust the level of the microphone preamps for each channel. The number near the knob shows which channel a gain knob controls (For example, the knob marked with a 1 controls channel 1, 2 controls channel 2, etc.).

Signal LEDs - Indicates the input level of the analog inputs. Green indicates an audio signal is present. A red Clip LED will illuminate when your input signal reaches -0.1 dBFS. At this level, the signal exhibits signs of clipping. Use the gain control knobs to keep the signal below this level.



Main Volume Knob - The Main Volume Knob controls the level for outputs 1-2 (Main L/R). It is active at all times and serves as an additional level control for outputs 1-2 when using the Quantum LT in standalone mode.



USB Status LED - The LED color shows if you are connected to a device via USB (computer or mobile device).

- A solid blue LED indicates that Quantum LT 16 is successfully connected to a device.
- A solid red LED indicates that Quantum LT 16 is not connected to a device.

Direct Monitor Button - Engages low-latency direct monitoring. The color of the button changes according to which mode it is set to.

When connected to USB:

- **Direct Off (Blue LED):** Default setting, direct monitoring is off.
- **Direct On (White LED):** Direct monitoring is on and can be configured using the Fender Universal Control app.
- **Fender Studio Pro Exclusive Mode (LED is off):** When engaging the hardware direct monitoring feature in Studio Pro, Studio Pro will take over direct monitoring control, the LED will turn off, and the button will be non-functional.

When not connected to USB, the LT will be in standalone mode and the USB status indicator will be red. When in standalone mode, the Direct button can be used to switch between the following settings:

- **Off (Blue LED):** Default setting. When in standalone mode, all input channels are set to -infinity to prevent accidental feedback.
- **Mixer Mode (White LED):** This recalls the mixer setting stored to the Quantum LT. In its default state, the mixer is active, all input faders are “up” at 0, and all input channels are mono and center panned. [For more information, see Section 5.5.](#)
- **Mic Pre Mode (Amber LED):** When using the Quantum LT 16 in standalone “Mic Pre Mode,” the mic preamps can be used as an expansion to an audio interface with multiple line inputs (or even another Quantum LT 16). [For more information, see Section 5.6.](#)



Headphone Knob - The Headphone Knob controls the headphone volume level.

Headphone Output - Connect stereo headphones to the 1/4-inch TRS stereo jack.



Power On / Off Button - Latching switch that turns the device on (pressed in) or off (out).

3.2 Front Panel (Quantum LT 4 and LT 2)



Fender Guitar Inputs - Your Quantum LT audio interface is equipped with 1/4-inch (TS) connectors for use with instruments like a guitar, bass, etc. The Quantum LT 4 has two instrument inputs, while the LT 2 has one. There is not a gain knob associated with these inputs—just plug and play!



Channel Gain Knob - Use this knob to increase or decrease gain for the mic inputs on the back panel. The Quantum LT 4 has two gain knobs, controlling channels 3 and 4. The Quantum LT 2 has one channel gain knob which controls channel 2.

Signal / Clip LEDs - Indicates the input level of the analog inputs.

Note: Green indicates an audio signal is present (-40dBfs or higher) and red indicates that the audio signal is clipping (-0.1 dBfs).

Phantom Power - Pressing the 48V button will turn phantom power on or off; the button will illuminate blue when 48v is inactive and illuminate red when 48V is active. Phantom power is global and will be applied to channels 1 and 2 when active.



Warning: Phantom power can damage some microphones. Check the manual for your microphone before engaging phantom power while using it. Always turn down your volume when engaging and disengaging phantom power.



Main Volume Knob - The Volume Knob controls the volume level of the Main L/R outputs (outputs 1 and 2).



USB Status LED - The LED color shows if you are connected to a device via USB (computer or mobile device).

- A solid blue LED indicates that the interface is successfully connected to a device.
- A solid red LED indicates that the interface is not connected to a device.

Direct Monitor Button - Engages low-latency direct monitoring. The color of the button changes according to which mode it is set to.

When connected to USB:

- **Direct Off (Blue LED):** Default setting, direct monitoring is off.
- **Direct On (White LED):** Direct monitoring is on and can be configured using the Fender Universal Control app.
- **Fender Studio Pro Exclusive Mode (LED is off):** When engaging the hardware direct monitoring feature in Studio Pro, Studio Pro will take over direct monitoring control, the LED will turn off, and the button will be non-functional.

When not connected to USB, the LT will be in standalone mode and the USB status indicator will be red. When in standalone mode, the Direct button can be used to switch between the following settings:

- **Off (Blue LED):** Default setting. When in standalone mode, all input channels are set to -infinity to prevent accidental feedback.
- **Mixer Mode (White LED):** This recalls the mixer setting stored to the Quantum LT. In its default state, the mixer is active, all input faders are “up” at 0, and all input channels are mono and center panned. [For more information, see Section 5.5.](#)



Headphone Knob - The Headphone Knob controls the output volume level for any headphones connected to the headphone output.

Headphone Output - Connect stereo headphones to the 1/4-inch TRS stereo jack.

3.3 Back Panel (Quantum LT 16)



Power Supply Connector - The Quantum LT 16 is powered via the included external power supply cable, a universal power supply capable of running any AV mains voltage from 100 to 240 V at 50 or 60 Hz.



USB-C Connector - Connect your Quantum LT 16 to your computer with the supplied USB-C to USB-C cable.

Note: Use of a different cable than the one included may affect performance or bus power.



MIDI Input and Output - One 5-pin MIDI input port and one 5-pin MIDI output port for sending and receiving MIDI data between your computer and external MIDI devices.



Line Outputs (Ch 3 - 8) – The Quantum LT 16 includes six TRS line outputs on 1/4-inch jacks for sending audio to line level devices. All LT 16 line outputs are DC-coupled for CV integration with CV-enabled equipment such as modular synths.



Main Outputs (Ch 1 - 2, Left and Right) - Use Main L and R to connect to your primary set of studio monitors.

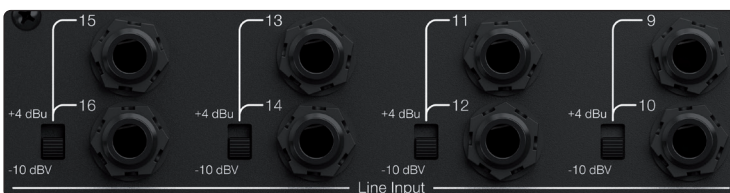

Line Input Level (Ch 9 - 16) - Use the two-way line input level switch to set the nominal level of adjacent Line Inputs to -10 dBV or +4 dBu.

Line Inputs (Ch 9 - 16) – Use the 8, 1/4-inch TRS connectors to connect to line level devices.

3.4 Back Panel (Quantum LT 4 and LT 2)



USB-C Device Connector - Connect Quantum LT 4 or LT 2 to your computer or mobile device with the included USB-C to USB-C cable.

Note: Use of a different cable than the one included may affect performance or bus power.

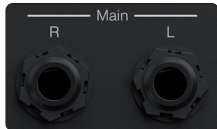

Main L and R - Use the two TRS 1/4-inch jacks labeled Main L/R to connect your studio monitors.



MAX-HD Microphone Preamps - Use the combo XLR / TRS connectors to connect microphones or line level sources. The Quantum LT 4 has two microphone preamps (Channel 3 and 4), while the LT 2 has one (Channel 2).

Note: Connecting a line level device through the 1/4-inch TRS input of the combo jack will bypass the mic pre.



Kensington Lock - Allows interface to be secured to a desk or other anchor point.

3.5 Quantum LT 16 Hookup Diagram

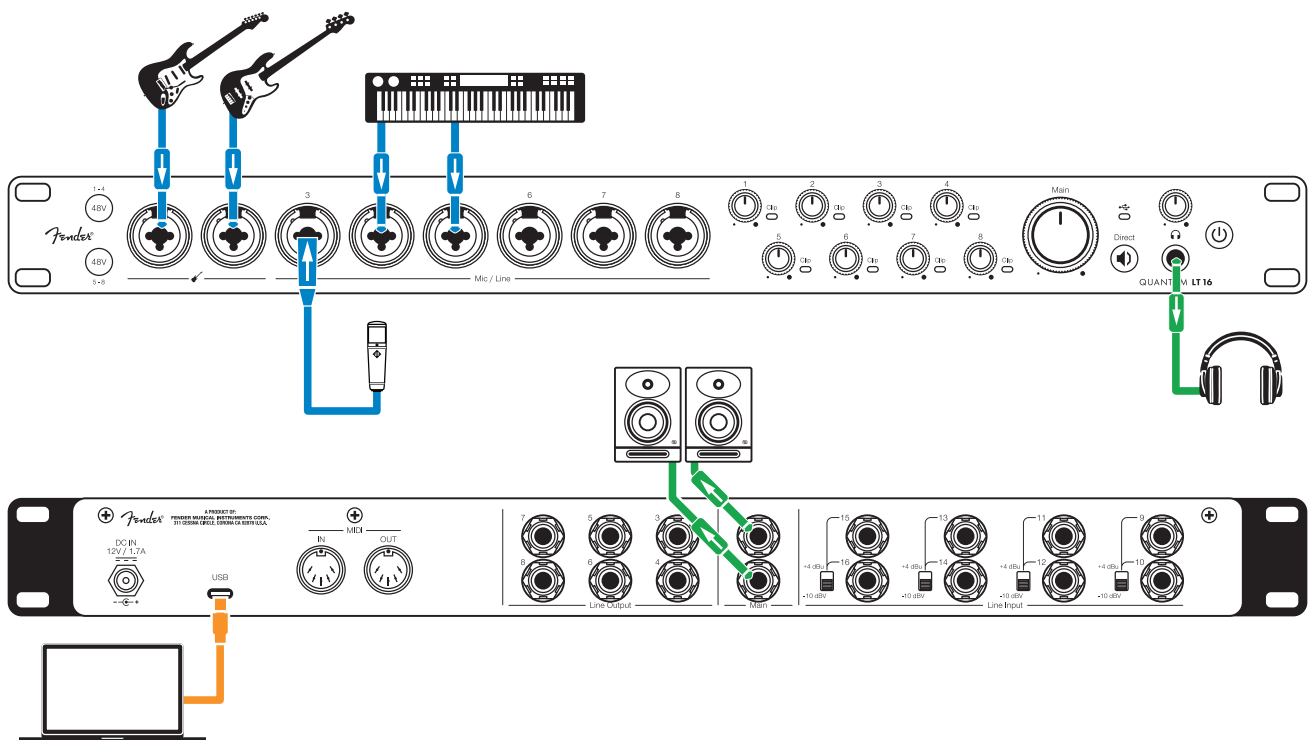

3.6 Quantum LT 4 Hookup Diagram

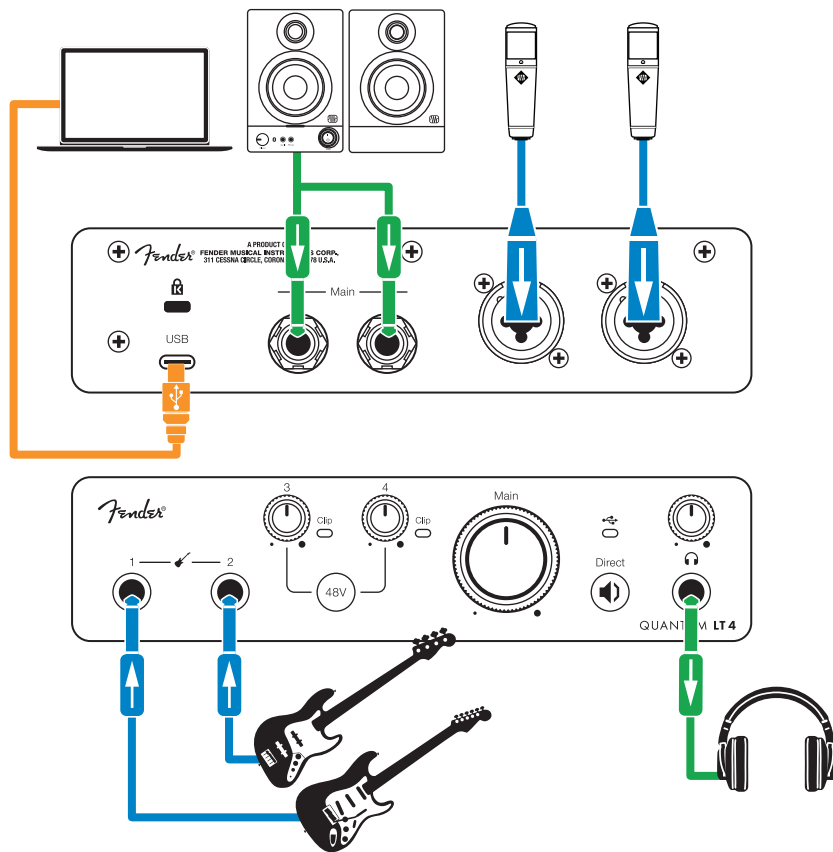

3.7 Quantum LT 2 Hookup Diagram

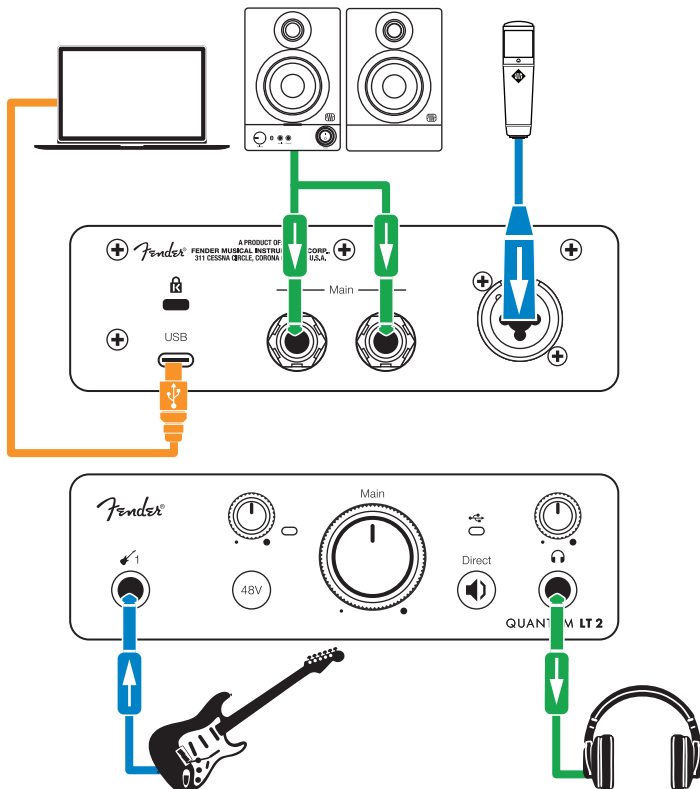

4 Software Features

Quantum LT's built-in integration with Fender Studio Pro and Universal Control ensures seamless hardware-software operation, allowing creators to fine-tune their direct mixes remotely for near-zero latency performance. **Please review the sections below for some more information about Universal Control and Fender Studio Pro integration.**

For more detailed information about Universal Control, Fender Studio Pro software integration, how to use Universal Control and more, download the “Quantum LT Software User Manual” from your MyFender account or in the Support dropdown menu of the Quantum LT product page on Fender.com.

4.1 Universal Control

Universal Control is both a driver-management utility and software control interface for your Quantum LT.



Universal Control provides the following:

- **Device Management:** From Universal Control's Start Page, you can quickly adjust your Sample Rate and Buffer Size (Windows Only). From here, you can also review your device's I/O formats, firmware, and serial number. You can update your firmware from the Start Page in Universal Control as well. For more information about updating firmware, **please see the Quantum LT Software User Manual.**
- **Low-Latency Direct Monitoring:** Using Universal Control eliminates the latency associated with DAW I/O buffering that makes monitoring problematic for the performer. By removing the DAW's software input monitoring feature from the monitoring signal flow altogether, the need to adjust I/O buffer sizes and latency is no longer an issue.
- **Direct Monitoring Mix Configuration:** Universal Control allows the user to adjust input fader levels, pan, channel linking, and solo/mute states, which are automatically saved to the hardware as they are updated during use. There are two settings:
 - » **Off:** This is the default Quantum LT Series direct monitor setting. All input faders are turned down to -infinity.
 - » **On:** In the default state, the mixer is active and input faders are set to 0 dB, so the user can hear their live signal direct without latency, in addition to computer playback stereo audio, which is set to -6 dB. In this default state, all input channels are mono and center-panned.
- **Send and Return Buses -** Universal Control has independent stereo sends per channel, as well as configurable returns for available buses. Available sends and returns vary by interface model.

4.2 Fender Studio Pro and Other Popular DAWs

The Quantum LT interface is compatible with any audio-recording application that supports Core Audio, WDM, or ASIO. To make the process of creating new music as seamless as possible, all Fender Quantum recording products come with access to Fender Studio Pro, a state-of-the-art audio recording, editing, mixing and mastering suite.

Quantum LT 2 and LT 4 devices come with a 6-month trial of Fender Studio Pro, while the Quantum LT 16 comes with a perpetual license for Fender Studio Pro.

4.2 Fender Studio Pro and Other Popular DAWs



After registering your Quantum LT, your Fender Studio Pro downloads will be available from within your MyFender user account. Download the Fender Studio Pro installer from your MyFender account:

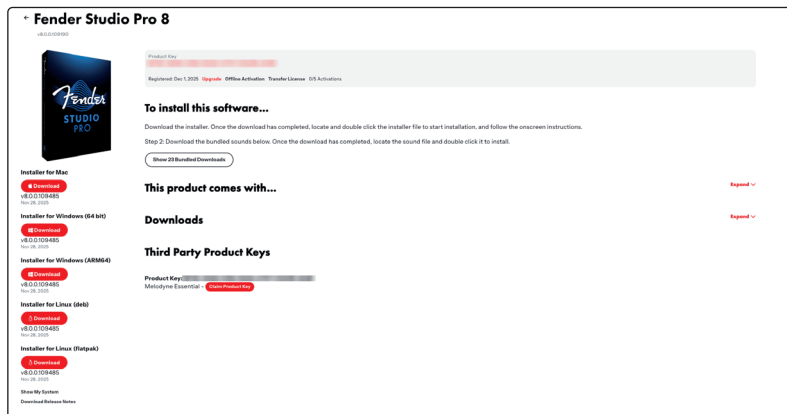

- **Windows users:** Launch the Fender Studio Pro installer and follow the onscreen instructions.
- **macOS users:** Drag the Fender Studio Pro application into the Applications folder on your Mac hard drive.

The first time you launch Fender Studio Pro, you will be prompted to install its companion content. Select the content you wish to add and click “Install.” The content will automatically begin to download and install from your MyFender user account.

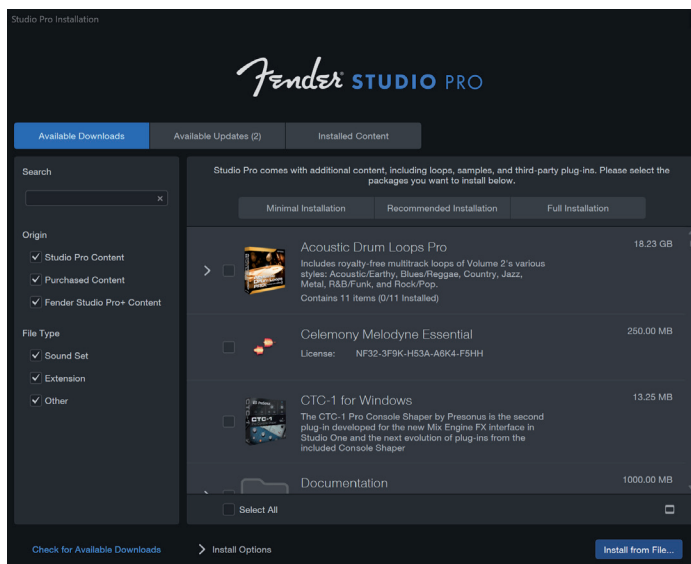

Operating instructions for Fender Studio Pro is beyond the scope of this Owner’s Manual, but Fender Studio Pro comes bundled with an array of demo and tutorial materials. Instructions are also available in the Fender Studio Pro Reference Manual and via our online Knowledge Base page.

If you’re using another DAW, please consult the documentation that came with your DAW for specific instructions on how to select the Quantum LT driver as the audio-device driver for your software.

5 Using Your Quantum LT

Once you've registered your new Quantum LT interface and downloaded all the required software, you are ready to start using the interface! The sections below detail how to use your Quantum LT.

5.1 Volume Control

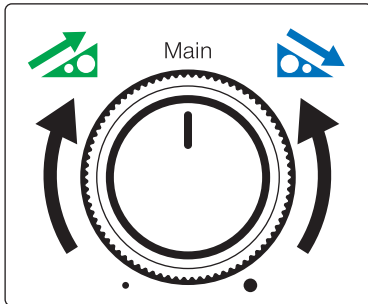

To control Output Volume:

- Turn the main volume knob clockwise to increase the output level.
- Turn the main volume knob counterclockwise to decrease the output level.

To control Headphone Output Volume:

- Turn the main headphone knob clockwise to increase the output level.
- Turn the main headphone knob counterclockwise to decrease the output level.

5.2 Setting a Channel's Gain Level

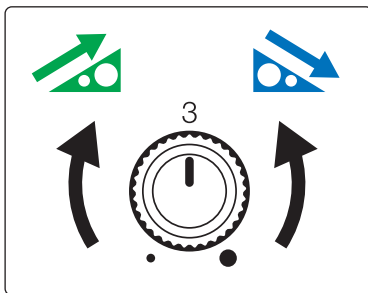

To control the input gain level of the Mic / Line / Instrument inputs:

- Turn the channel gain knob clockwise to increase the gain level.
- Turn the channel gain knob counterclockwise to decrease the gain level.
- The Instrument inputs on Quantum LT 2 and LT 4 are plug-and-play and do not have a gain control.

5.3 Changing Line Input Level (Quantum LT 16 Only)

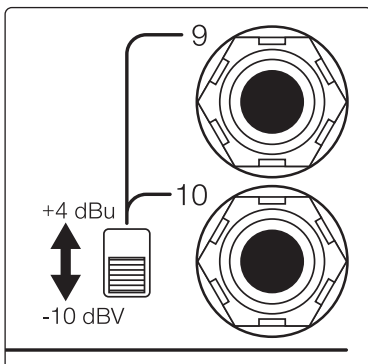

The rear-panel line level inputs (Ch 9 - 16) can be set *in pairs* for either +4 dBu or -10 dBV operation.

5.4 Monitor Without Latency

Low-latency direct monitoring can be enabled by pressing the Direct button on the front panel of the Quantum LT or by turning the feature on within Universal Control.

When low-latency direct monitoring is turned on, the Mic, Line, and Instrument inputs can be monitored directly to eliminate latency or "lag" while listening to yourself perform or speak in your music software. Low-latency direct monitoring works by routing a mix of the Quantum LT's input channels directly to the main output before the signal goes to the analog-to-digital converter.

By default, low-latency direct monitoring is set to "Off" (blue LED). This prevents the user from inadvertently hearing the input signal twice (once from the hardware direct monitoring, and again as a delayed signal from the software monitoring), which can cause unwanted doubling, echo, and/or phase cancellation of the input signal.

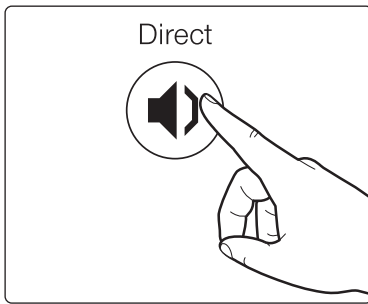

- Press the Direct button once to engage low-latency direct monitoring (white LED). In the default state, the mixer is active and input faders are set at 0 dB, so the user can hear their direct live signal without latency in addition to computer playback stereo audio (set to -6 dB). In this default state, all input channels are mono and center-panned. If the user has enabled low-latency direct monitoring, changes to the mix configuration in Universal Control (fader levels, pan position, channel linking, and solo/mute setting) are automatically saved to the Quantum LT and will be recalled by enabling low-latency direct monitoring.
- Press the Direct button again to turn low-latency direct monitoring off (Direct LED will turn back to blue).
- When using Fender Studio Pro's hardware low-latency monitoring feature, the direct monitoring mix is controlled using Fender Studio Pro, and the Universal Control mixer and Direct button on the front panel of the Quantum LT will be non-functional.

Note: The Direct button can be customized to find the perfect volume balance of computer playback and Quantum LT inputs. By default, input faders are set to 0 dB, and playback faders set to -6 dB. **See the Quantum LT Software User Guide for additional details.**

5.5 Using the Quantum LT as a Standalone Mixer

When not connected to a computer (USB Status LED will be solid red), the Quantum LT will send (sum) all analog inputs to Main Outputs 1 and 2. This lets you use the inputs and main outs as a simple mixer to send audio to another mixer, speakers, or listen with headphones when the computer is off, as long as the Quantum LT is powered. "Mixer Mode" is the default standalone mode on all Quantum LT interfaces.

When using the Quantum LT in Mixer mode, you can use the interface to:

- Adjust the volume of the main output.
- Adjust the volume of the headphone output.
- Adjust the input gain of a channel.
- Turn 48V on or off for groups.
- Use the Direct button to toggle monitoring between Off (mute all) and On.
- Switch the operating level for the rear panel line inputs between +4/-10 dBu (**LT 16 only**).

While in standalone mode, press the Direct Button on Quantum LT to cycle between the Off and On monitoring modes.

- **Off (blue LED):** Default setting. When in standalone mode, all input channels are set to -infinity to prevent accidental feedback.
- **On (white LED):** This recalls the mixer setting stored to the Quantum LT. In its default state, the mixer is active, and all input faders are set to 0.0dB, and all input channels are mono and center panned. Playback channels default to -6.0 dB.
- Any changes to the mix configuration in Universal Control (fader levels, pan position, channel linking, and solo/mute setting) while connected to a computer are automatically saved to the Quantum LT and can be recalled while in standalone mode by switching the Direct monitoring setting on with the Direct button on the front panel.

5.6 Standalone "Mic Pre Mode" (Quantum LT 16 only)

The Quantum LT 16 can also function as a standalone mic preamp. When using the Quantum LT 16 in standalone "Mic Pre Mode," the mic preamps can be used as an expansion to an audio interface with multiple line inputs (or even another Quantum LT 16). The mic preamps will directly pass signals to their corresponding analog output. For example, Channel 1 will send its signal directly to output 1, and so on.

Note: The Main output knob controls the output level for analog outputs 1 and 2 (Main L/R) in all modes. When using Mic Pre mode, the Main output knob must be turned up to pass signal to the Main L/R outputs. When the Main Out knob is turned 100% clockwise, it is functioning at unity gain.

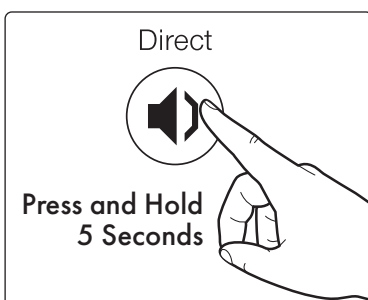

- To enter standalone "Mic Pre Mode": Ensure that Quantum LT 16 is not connected to the host (red USB status indicator), then press and hold the Direct button for 5 seconds to go into "Mic Pre Mode" (Direct button will change to amber).
- To exit "Mic Pre Mode" and return to "Mixer Mode": Press and hold the Direct button again for 5 seconds (color will change back to white or blue).

WARNING: Always be sure to turn the Main and Headphone Output Knobs down when updating the interface, switching modes or when connecting or disconnecting USB or audio cables.

6 Resources

6.1 Specifications

AD / DA CONVERSION

Sample Rates 44.1, 48, 88.2, 96, 176.4, 192 kHz

Converter Resolution 24-bit

INPUTS

Instrument Inputs

Connector Type ¼-inch Female

Maximum Input Level Quantum LT 2 and LT 4: +12 dBu
Quantum LT 16: +22dBu

Frequency Response 20 Hz to 20 kHz

Dynamic Range 114 dB

THD + N 0.001%

Input Impedance 1M Ohms

Microphone Inputs

Connector Type Combo-style, XLR / TRS (digital control, +75 dB mic range)

Maximum Input Level Quantum LT 2 and LT 4: +15 dBu
Quantum LT 16: +18dBu

Gain Range 0 to +75 dB

Frequency Response 20 Hz to 20 kHz

Dynamic Range 115 dB

THD + N 0.001%

EIN -128.6 dBu

Input Impedance 1600 Ohms

Phantom Power 48V

Line Inputs

Connector Type Combo-style, XLR / TRS

Maximum Input Level Quantum LT 2 and LT 4: +15 dBu
Quantum LT 16: +18dBu

Frequency Response 20 Hz to 20 kHz

Dynamic Range 115 dB

THD + N 0.001%

Gain Range 0 to +26 dB

Input Impedance 10K Ohms

OUTPUTS

Main Outputs

Connector Type ¼-inch Female, TRS

Maximum Output Level Quantum LT 2 and LT 4: +15 dBu
Quantum LT 16: +18dBu

Frequency Response 20 Hz to 20 kHz

Dynamic Range 115 dB

THD + N 0.001% (1 kHz, +4 dBu)

Trim Range -∞ dB to 0 dB



Line Outputs (LT 16 Only)			
Connector Type	¼-inch Female, TRS (DC-coupled)		
Maximum Output Level	+18 dBu (Balanced)		
Frequency Response	20 Hz to 20 kHz		
Dynamic Range	115 dB		
THD + N	0.001%		
Output Impedance	51 Ohms		
Trim Range	-∞ dB to 0 dB		
Headphone Outputs			
Connector Type	¼-inch Female, TRS (1-4)		
Maximum Output Level	Quantum LT 2 and LT 4: 46 mW/Channel Quantum LT 16:142 mW/channel		
Frequency Response	20 Hz to 20 kHz		
Dynamic Range	114 dB		
THD + N	0.001%		
Output Impedance	33 Ohms		
Trim Range	-∞ dB to 0 dB		
DIGITAL I/O			
MIDI I/O			
Connector Type	5-pin DIN (off DB-9)		
PRODUCT DIMENSIONS	QUANTUM LT 16	QUANTUM LT 4	QUANTUM LT 2
Length	5" (127mm)	3.5" (88mm)	3.5" (88mm)
Width	19" (483mm)	7" (178mm)	5.5" (139.7mm)
Height	1.7" (44mm)	1.75" (44.45mm)	1.75" (44.45mm)
Weight	4.8 lbs (2.2 kg)	1.8. lbs (.82kg)	1.125 lbs (.51kg)



311 CESSNA CIRCLE • CORONA, CALIF. 92878 • USA
WWW.FENDER.COM

Part# 70-22000507-A